

RESALIVA Collection Tube User manual



Do not eat, drink, smoke or use mouthwash 30 minutes before the test.



Wash/disinfect your hands.

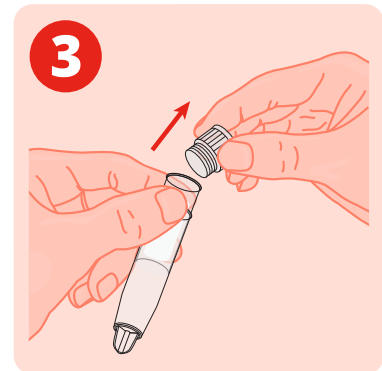

Carefully open the collection tube.



Put the sponge into your mouth without using hands.

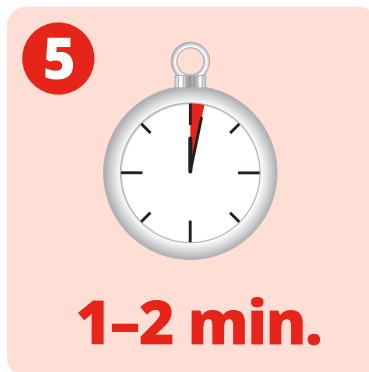

Without chewing leave the sponge in your mouth for 1-2 minutes.



Using your mouth, place sponge back into the tube.



Close the tube properly.



Stick the bar code near the bottom part of the tube.

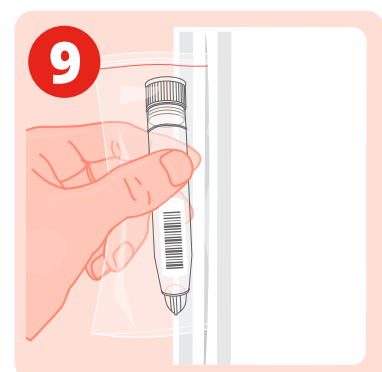

Insert the collection tube in the plastic bag and the bag into the envelope and send it to the lab.

Part number **GS-316** Sample test tube | orders@genespector.com